

(V)
+

P

LH

LT

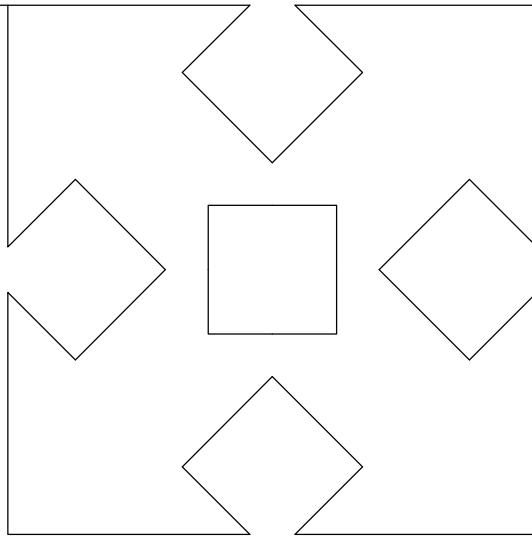

U9

La perspectiva cónica

FIGURA
47

EXERCICI
15

NOM

DATA

NOTA

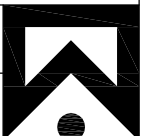

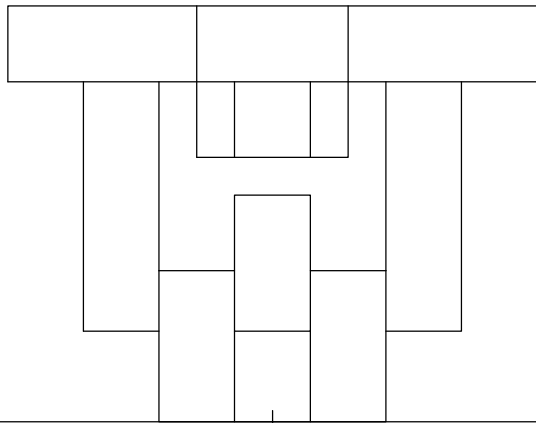
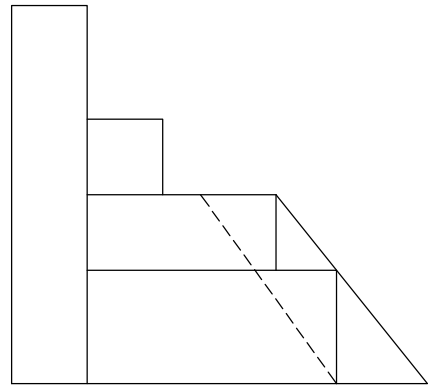
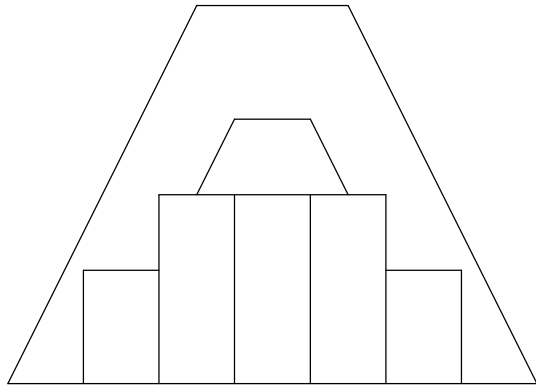

π

LH

V

LT

U9

La perspectiva cónica

FIGURA
48

EXERCICI
16

NOM

DATA

NOTA

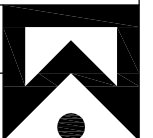

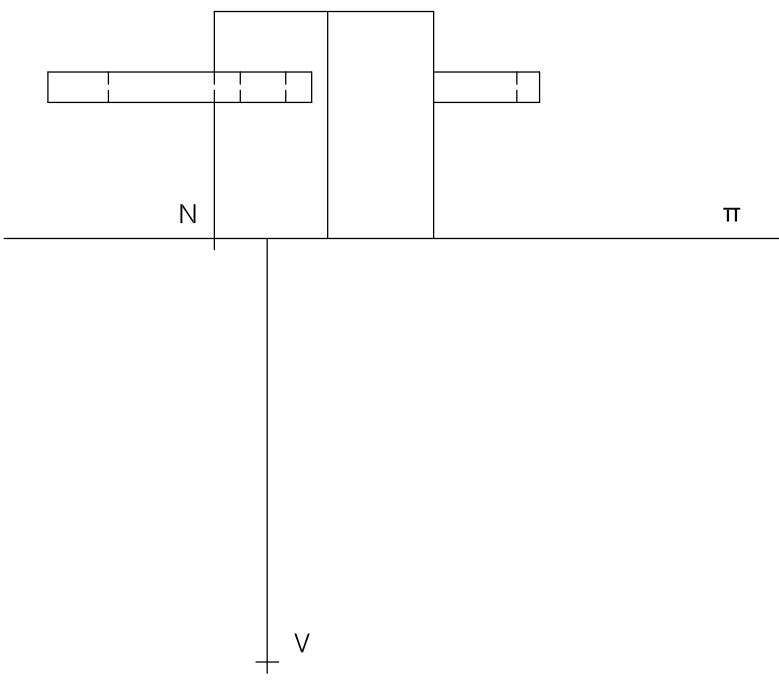
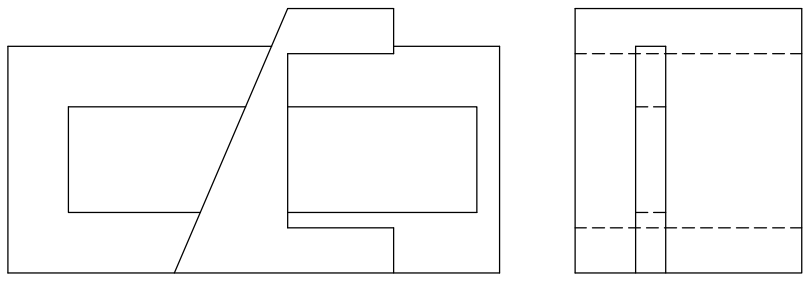

_____ LH

_____ N _____ LT

U9	La perspectiva cónica	FIGURA 49	EXERCICI 17
NOM	DATA	NOTA	

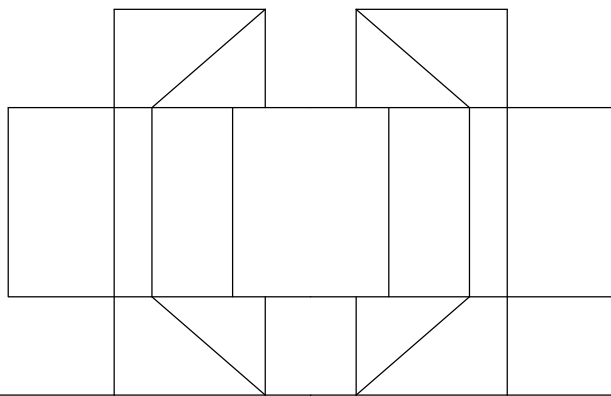
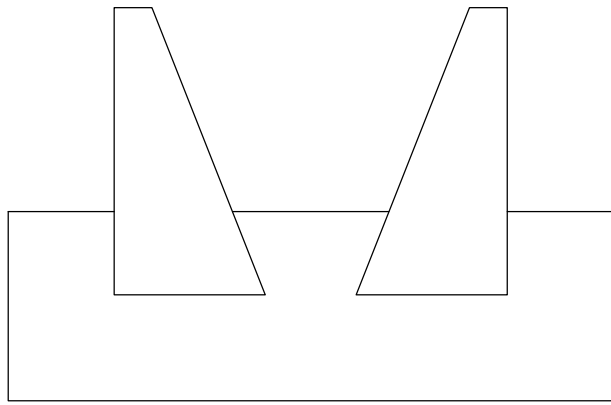
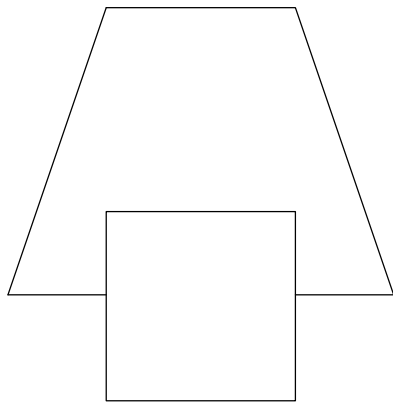

V

LH

LT

U9

La perspectiva cónica

FIGURA
50

EXERCICI
18

NOM

DATA

NOTA



- Dades geomètriques per a la realització de l'exercici:
1. Làmina en posició horitzontal.
 2. Situa la línia de l'horitzó a 80 mm de la vora superior de la làmina.
 3. Situa el punt P a 180 mm de la vora esquerra de la làmina.

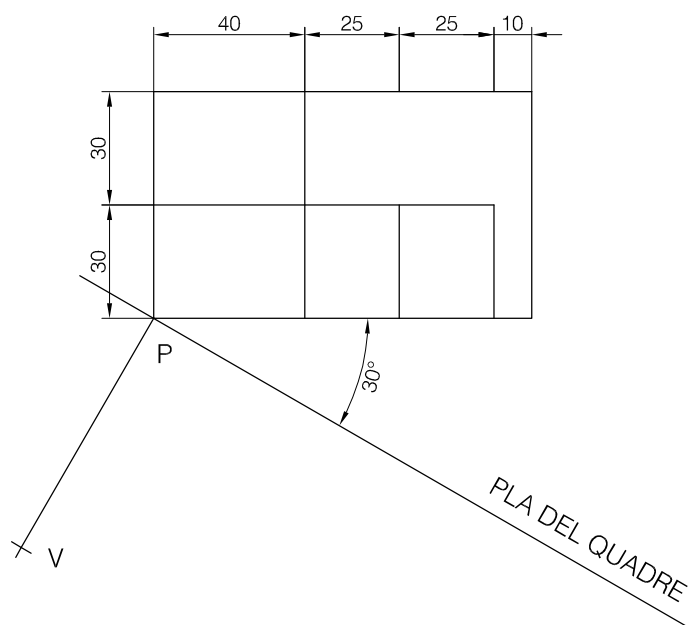
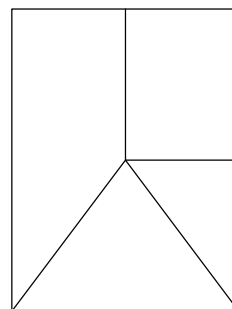
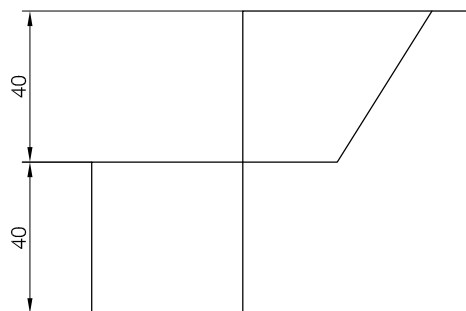

U9

La perspectiva cònica

FIGURA

51

EXERCICI

19

NOM

DATA

NOTA

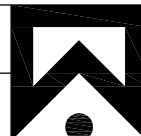

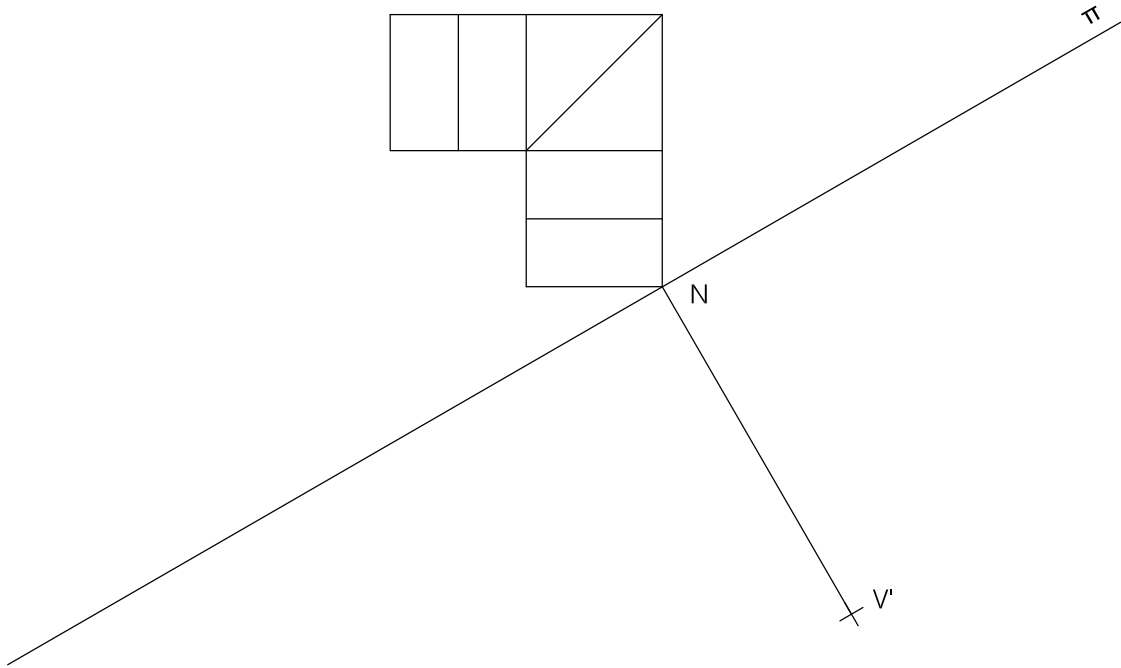
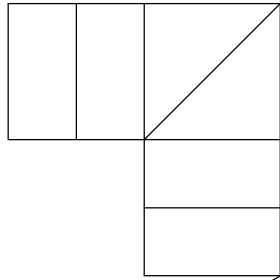
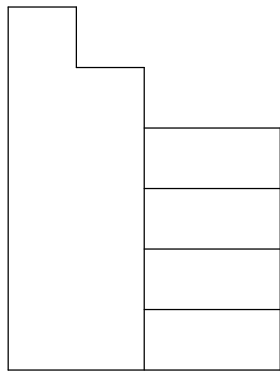

_____ LH

_____ LT
N

U9	La perspectiva cónica	FIGURA 52	EXERCICI 20	
NOM		DATA	NOTA	

- Dades geomètriques per a la realització de l'exercici:
1. Làmina en posició horitzontal.
 2. Situa la línia de l'horitzó a 60 mm de la vora superior de la làmina.
 3. Situa el punt P a 73 mm de la vora dreta de la làmina.

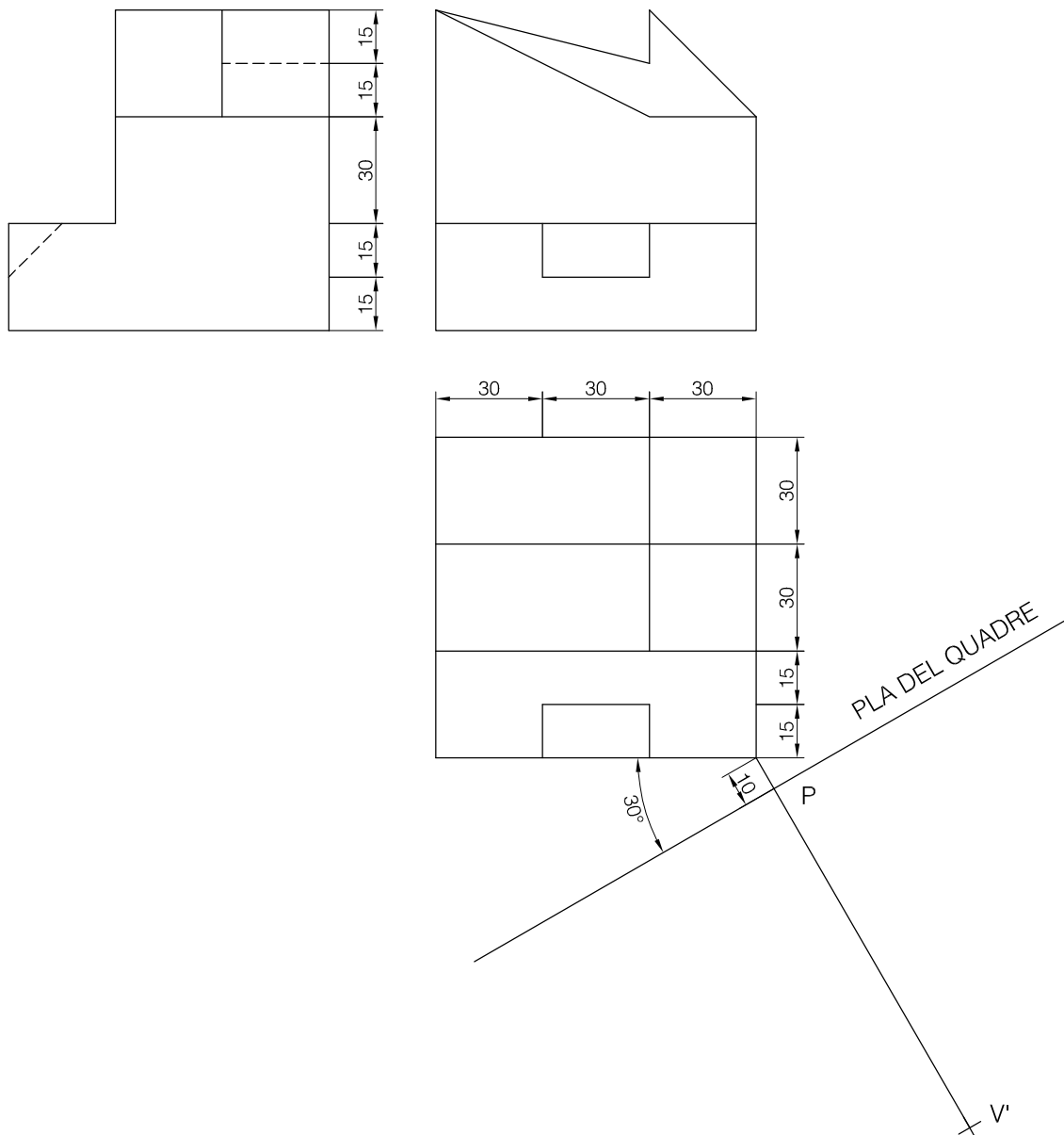

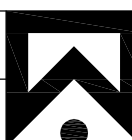
U9	La perspectiva cònica	FIGURA 53	EXERCICI 21
NOM	DATA	NOTA	

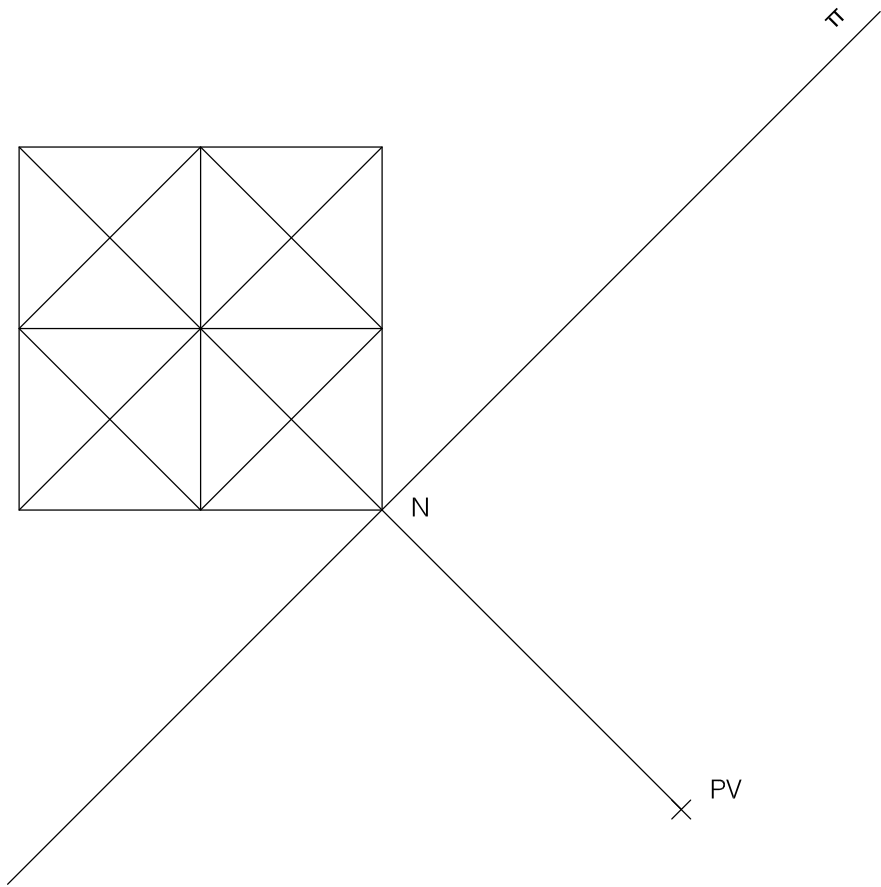
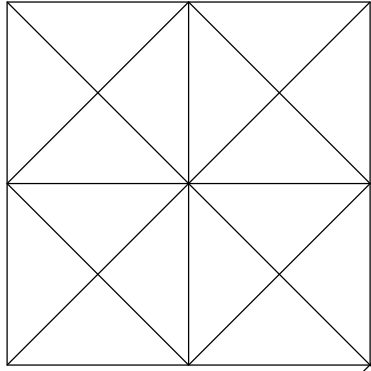
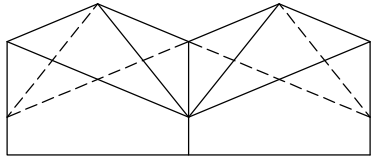

_____ LH

_____ LT
| N

U9	La perspectiva cónica	FIGURA 54	EXERCICI 22
NOM	DATA	NOTA	

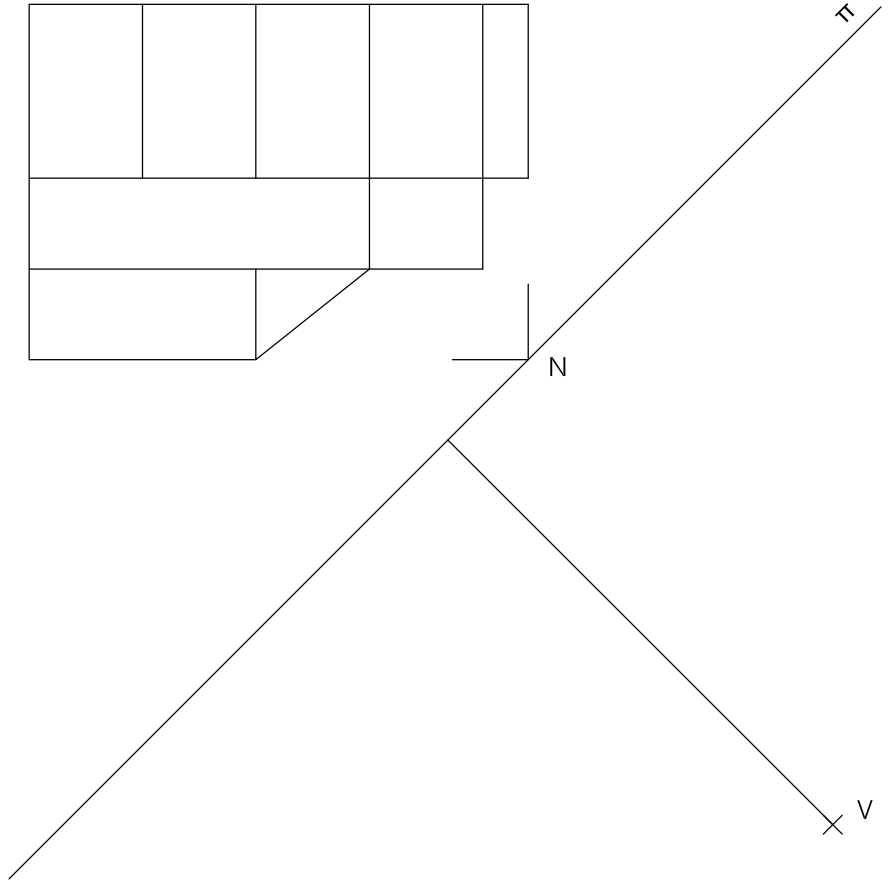
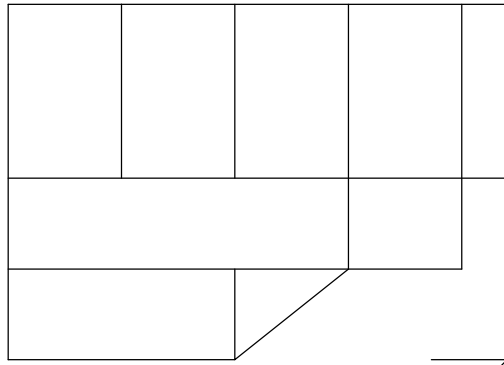
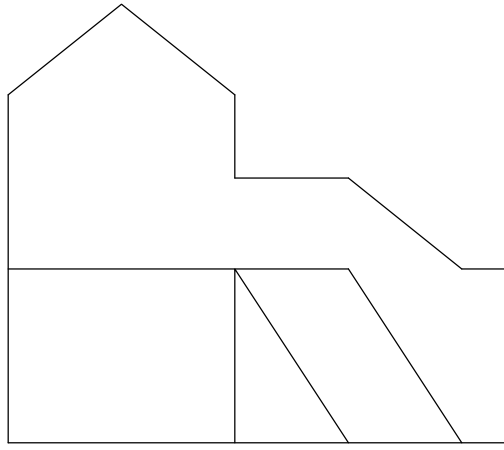
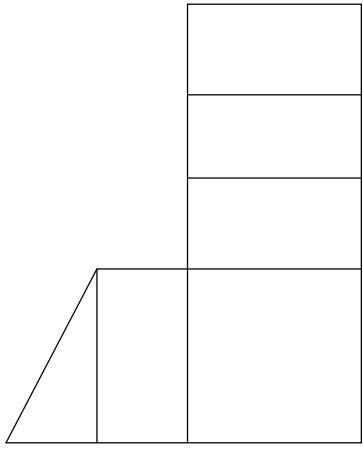

U9

La perspectiva cónica

FIGURA
55

EXERCICI
23

NOM

DATA

NOTA

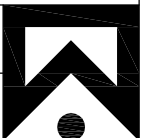

Dades geomètriques per a la realització de l'exercici:

1. Làmina en posició horitzontal.
2. Situa la línia de l'horitzó a 25 mm de la vora superior de la làmina.
3. Situa el punt P a 140 mm de la vora dreta de la làmina.

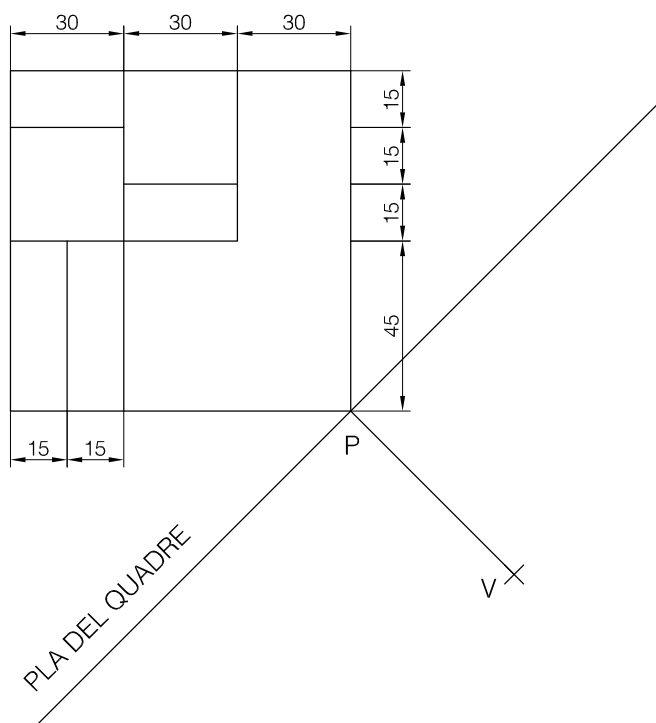
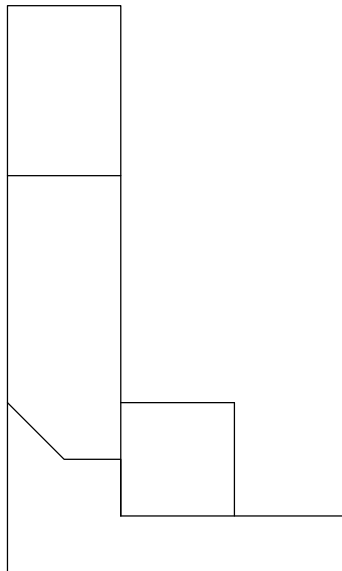
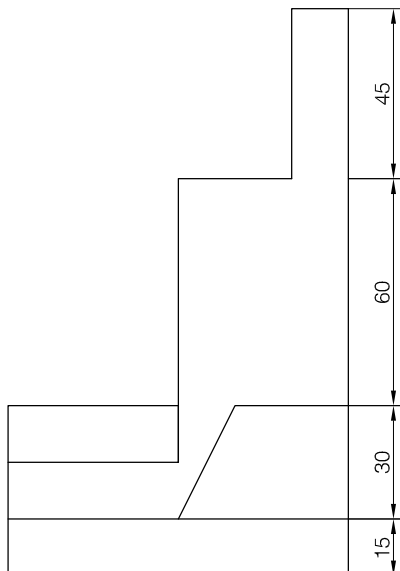

U9

La perspectiva cònica

FIGURA

56

EXERCICI

24

NOM

DATA

NOTA

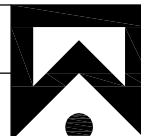

Dades geomètriques per a la realització de l'exercici:

1. Làmina en posició horitzontal.
2. Situa la línia de l'horitzó a 90 mm de la vora superior de la làmina.
3. Situa el punt P a 70 mm de la vora dreta de la làmina.

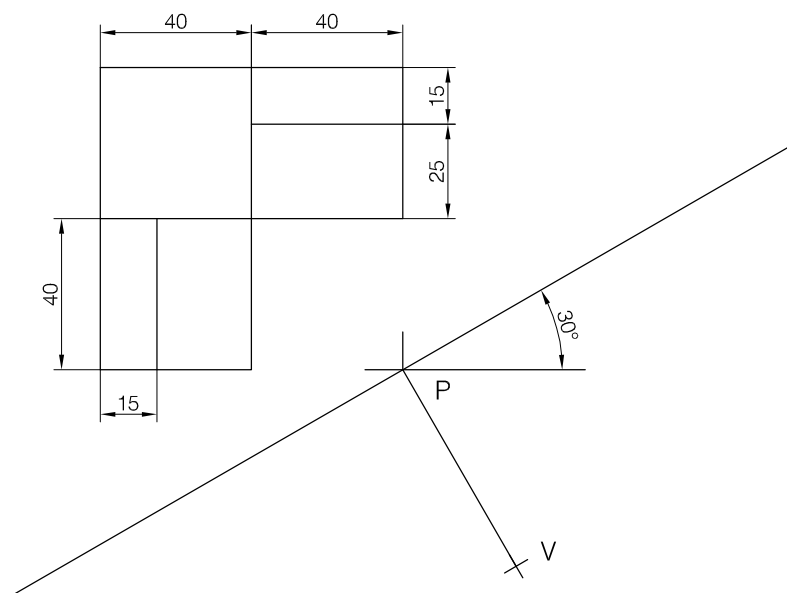
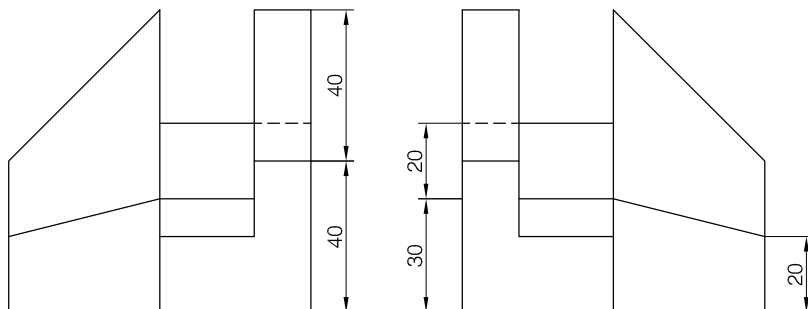

U9

La perspectiva cònica

FIGURA

57

EXERCICI

25

NOM

DATA

NOTA

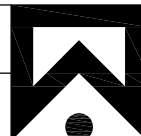

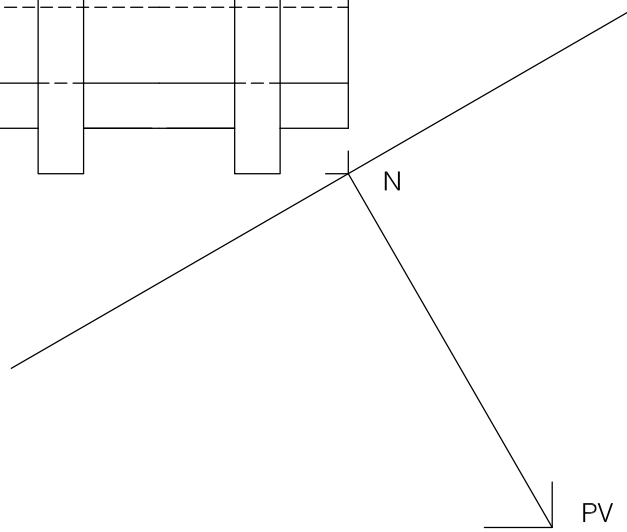
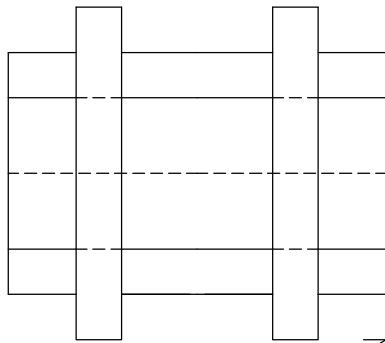
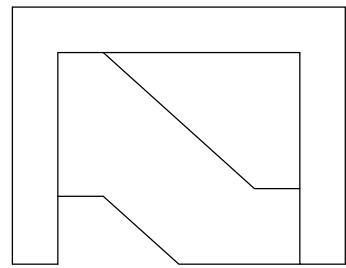
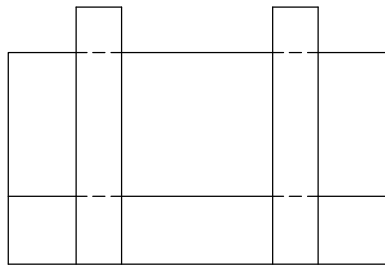

_____ LH

_____ LT

U9	La perspectiva cónica	FIGURA 58	EXERCICI 26	
NOM	DATA		NOTA	